

Without a doubt, the person who influenced me the most with sewing and crafting was my mom. With an abundance of patience and kindness she shared her knowledge with me from a very early age. She had the daintiest of hands that created such beautiful things for our home. I loved to watch her create and found such peace and contentment as we worked together at the sewing machine. I designed this block with red in the center, representing Mom's heart. Radiating from her to future generations we will go hand in hand creating, sewing, loving.

# Hand in Hand

for the Splendid Sampler™

Kari Carr

Finished Block Size 6" x 6"

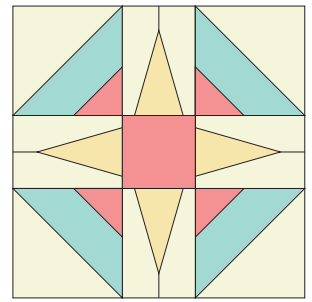

## Requirements

- # 1 square - 10" x 10" (fabric A)
- # 1 rectangle - 4" x 8" (fabric B)
- # 1 square - 6" x 6" (fabric C)
- # 1 square - 10" x 10" (fabric D)

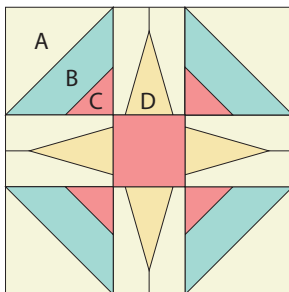

## Cutting Instructions

From fabric A cut:

- ✂ 2 squares - 3 1/2" x 3 1/2"
- ✂ 8 rectangle - 1 1/4" x 2 3/4"

From fabric B cut:

- ✂ 2 squares - 3 1/2" x 3 1/2"

From fabric C cut:

- ✂ 4 squares - 1 1/2" x 1 1/2"

- ✂ 1 square - 2" x 2"

From fabric D cut:

- ✂ 4 template D

## Preparation

1. Draw a diagonal line on wrong side of fabric A - 3 1/2" x 3 1/2" squares and 4 fabric C - 1 1/2" x 1 1/2" squares.

## Block Assembly

### Corner units

1. Place a fabric A - 3 1/2" x 3 1/2" square and a fabric B - 3 1/2" x 3 1/2" square right sides together.
2. Sew 1/4" on either side of the drawn line.
3. Cut on the drawn line. Press to the darker fabric. Trim half square triangle (HST) unit to 2 3/4" x 2 3/4" square.
4. Yields 2 - HST units. Make 4 in total.

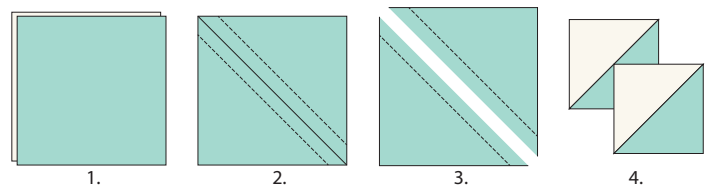

5. Select a HST unit.
6. Place a fabric C - 1 1/2" x 1 1/2" on the corner of a HST unit.
7. Sew on the drawn line.
8. Trim leaving a 1/4" seam allowance. Press corner triangle outwards.

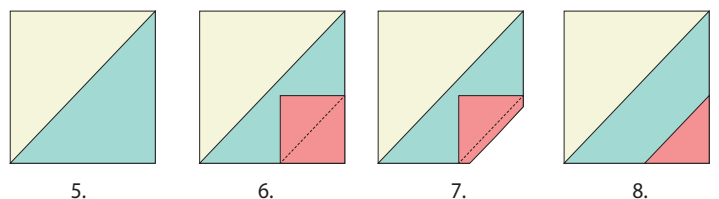

9. Make 4 corner units in total.

**Folded triangle unit**

1. Fold fabric D piece, wrong sides together, in half lengthwise.
2. Position a folded fabric D piece on fabric A - 1 ¼" x 2 ¾" rectangle.
3. Place a second fabric A - 1 ¼" x 2 ¾" rectangle on top, right sides together. Sew a ¼" seam through all layers.
4. From the right side, refold fabric D piece so the fold is lined up with the seam line. Press the seam allowance open to create a triangle.
5. Make 4 folded triangle units in total. Unfinished folded triangle unit size - 2" x 2 ¾"

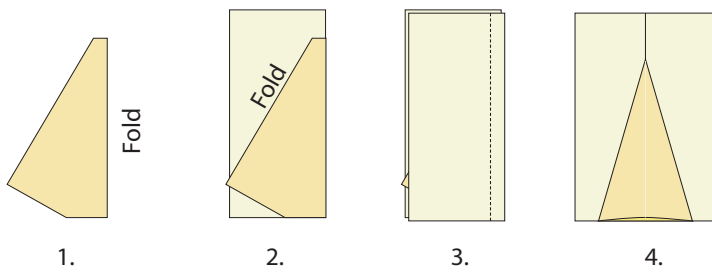

**Finishing the block**

1. Arrange units and sew rows.
2. Sew rows together. Press in direction of arrows.

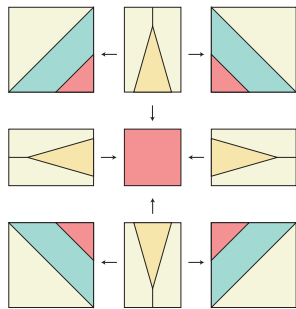

Seam allowance included

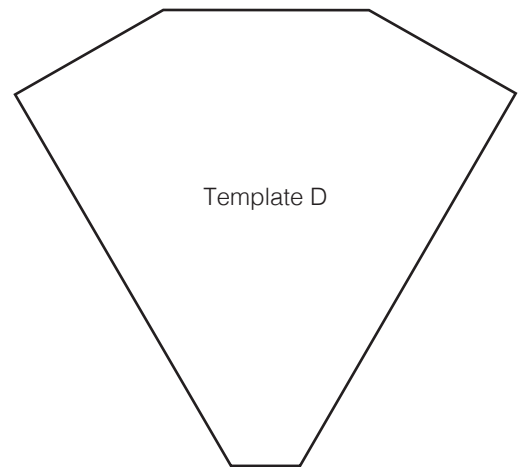

1 inch

Do not scale or 'Fit to Page'



www.newleafstitches.com

#TheSplendidSampler

© Copyright 2015 Kari Carr. This pattern is for personal use only. It cannot be used for commercial purposes. It cannot be copied or distributed in any format. It cannot be used with distribution of any product, including kits or made into a pattern for re-sale without the written permission from the designer.

