

*Playing with my Gran's old buttons while she sewed clothing on her sewing machine was something I loved to do and something that I still love to do. Gran taught me the names of wild flowers and animals, how to use watercolour paints and helped me with my first tentative embroidery stitches. I still have some of those early pieces of embroidery. As I stitch I often think, Gran would have loved to see how much my embroidery has improved!*

# Gran's Button Jar

for the Splendid Sampler™

Lynette Anderson

Finished Block Size 6" x 6"

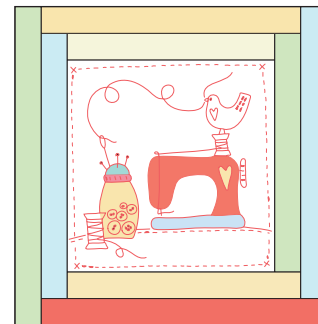

## Requirements

- ✂ 1 - 4½" x 4½" square cream tonal, background
- ✂ 8 assorted print strips 1" wide by maximum 6½" in length
- ✂ 6 strand embroidery floss to suit your fabrics
- ✂ Stitchery Stabilizer - single side fuse, optional
- ✂ Roxanne's Glue Baste It™, optional
- ✂ Appliquick Rods™, optional
- ✂ Appliqué Paper, water-soluble single side fuse, optional
- ✂ Fabric glue pen, optional
- ✂ Fine tipped fabric marking pen
- ✂ Light box, optional
- ✂ General sewing supplies

## Cutting

- ✂ A: 1 - 1" x 4½"
- ✂ B: 1 - 1" x 5"
- ✂ C: 1 - 1" x 5"
- ✂ D: 1 - 1" x 5½"
- ✂ E: 1 - 1" x 5½"
- ✂ F: 1 - 1" x 6"
- ✂ G: 1 - 1" x 6"
- ✂ H: 1 - 1" x 6½"
- ✂ Centre Square - 4 ½" x 4 ½"

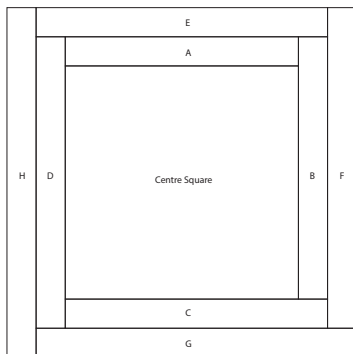

## Block Assembly

1. Join each strip in order to the centre square, pressing each seam outwards before joining the next strip.

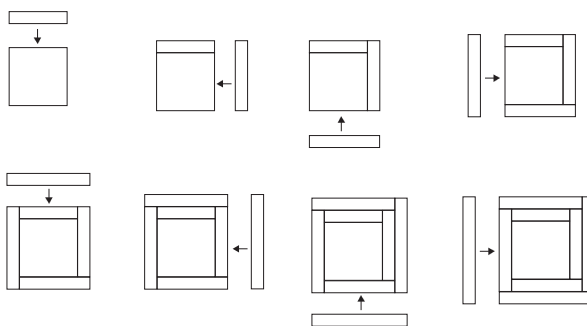

## Transferring The Design

1. Using a light source such as a light box or a window, with right side facing up centre the design over the pattern sheet. Trace the design onto the stitchery fabric using a suitable fine tipped fabric marking pen.

## The Appliqué

1. Using your favourite method of appliqué, prepare all the pieces that are to be appliquéd. Depending on which type of appliqué you decide to do you may need to either add seam allowance to the shapes for traditional needle turn appliqué or for fusible web appliqué you will need to reverse the shapes.
2. I chose to use needle turn appliqué for my sample and to do this I used the revolutionary Appliquick™ rods and water-soluble appliqué paper. I have a very nice tutorial page that includes how to use the Appliquick tools on my blog, so please take the time to visit [http://lynetteandersondesigns.typepad.com/lynette\\_anderson\\_designs/tutorials.html](http://lynetteandersondesigns.typepad.com/lynette_anderson_designs/tutorials.html)
3. Using the picture as a guide, position the appliqué shapes. To make this job easier I use my light box. I place the pattern sheet onto the light box, then position the background fabric on top. You can usually see through the fabric well enough to position the appliqué shapes.
4. Once you are happy with the positioning glue-baste or pin the appliqué shapes in place.

\*Tip: When using traditional appliqué, I use a basting glue to fix the shapes in position on the background. Roxanne's Glue Baste It™ has a small tube through which tiny drops of glue emerge, allowing for fine placement of the glue. You could use pins but I don't like the way the thread gets caught around the pins when I'm sewing the shapes into place.

5. Stitch the appliqué shapes in position using a blind hem stitch, I use thread that matches my background fabric so it doesn't show.

### Fusible Stitchery Stabilizer:

1. If you are using an iron-on stitchery stabilizer you will need to iron it on before the stitchery can be started, by putting this on the back of your stitchery you will not get shadows from the threads on the back of your work.
2. On close inspection of your iron-on stitchery stabilizer you will see that it is shiny on one side. Place the shiny side to the wrong side of your fabric. Following the manufacturer's instructions bond iron-on stitchery stabilizer to wrong side of your fabric.

### Stitches used are:

Back stitch (BS), satin stitch (SS), cross stitch (CS), running stitch (RS) and French knots (FN). Please use two strands of embroidery floss for all the embroidery.

Once all your stitching has been completed, gently press your block.

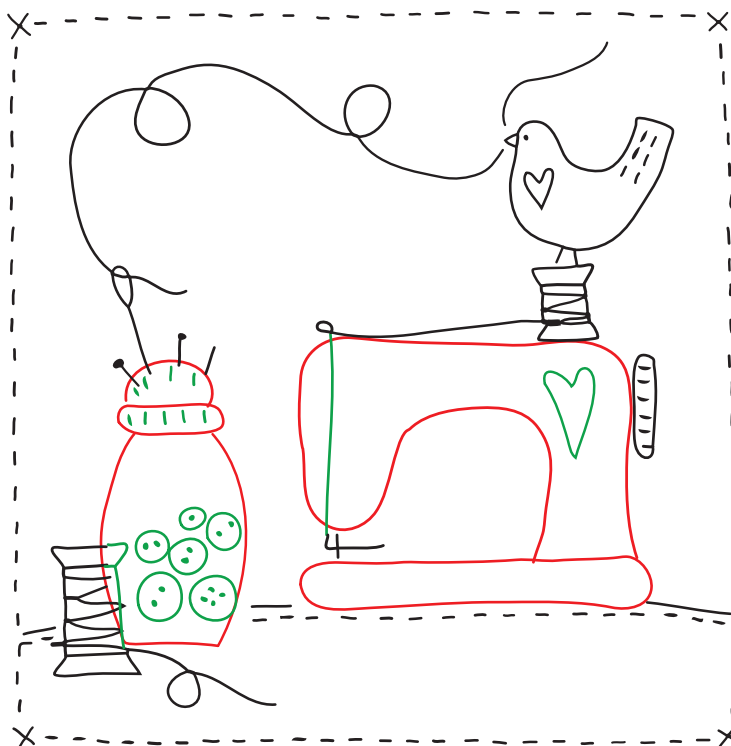

Templates are not in reverse



Use this diagram as a guide for appliqué placement and stitchery lines.

Red lines - appliqué placement

Black lines - stitchery lines

Green lines - surface stitchery (over appliqué)

Do not 'fit to page' or scale

1 inch



Do not 'fit to page' or scale

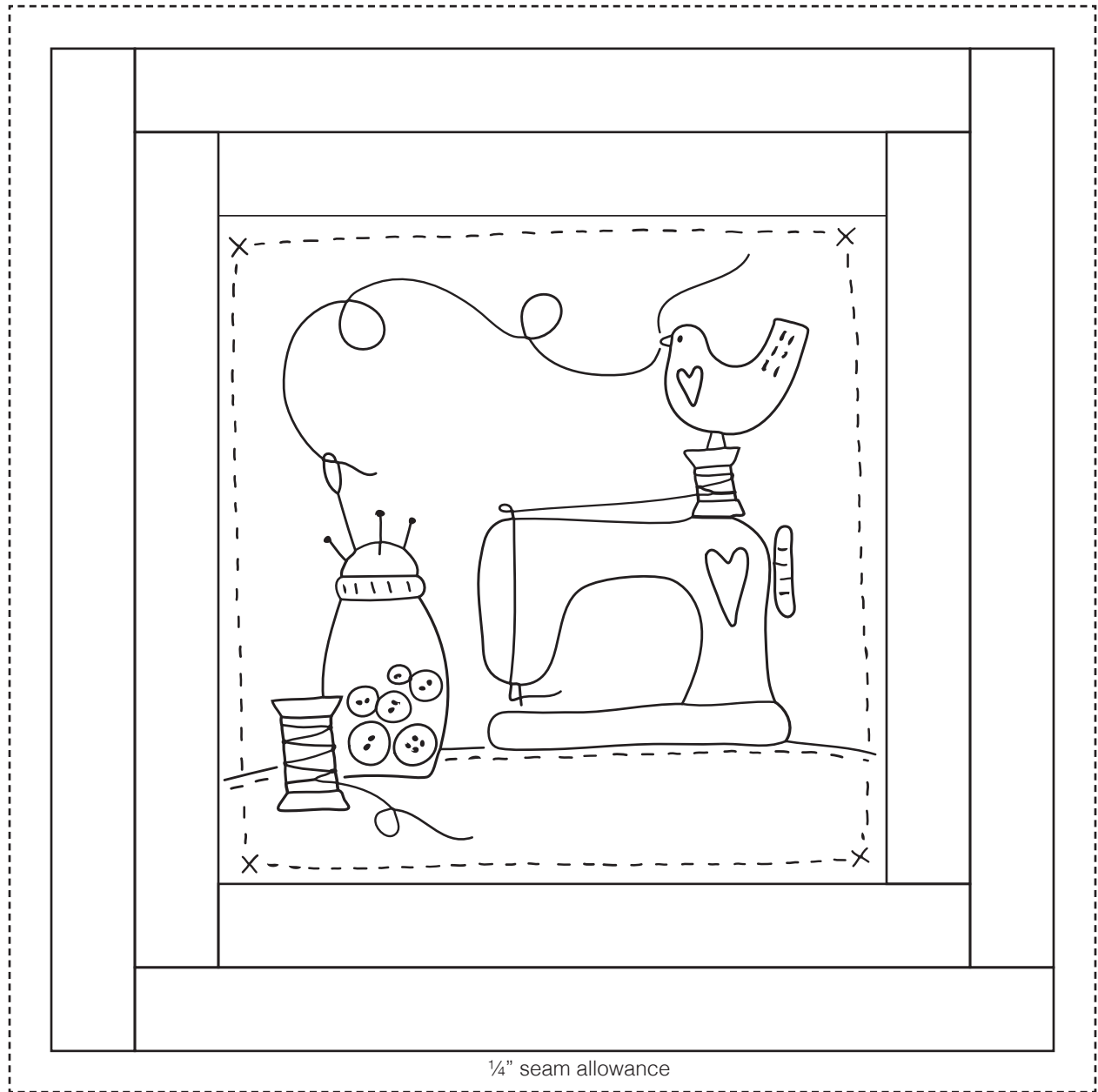

1 inch

#TheSplendidSampler

© Copyright 2015 Lynette Anderson. This pattern is for personal use only. It cannot be used for commercial purposes. It cannot be copied or distributed in any format. It cannot be used with distribution of any product, including kits or made into a pattern for re-sale without the written permission from the designer.

